

3 BEDROOMS, 3.5 BATHS

UNIT 204 INTERIOR 2,356 SF EXTERIOR 793 SF TOTAL 3,149 SF

UNIT 304 INTERIOR 2,375 SF EXTERIOR 793 SF TOTAL 3,168 SF

UNIT PH-4 INTERIOR 2,375 SF EXTERIOR 793 SF TOTAL 3,168 SF ROOF TERRACE 684 SF

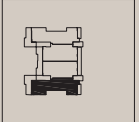

Stated dimensions are measured to the exterior boundaries of the exterior walls and the centerline of interior opening walls and may vary from the dimensions that would be determined by using the description and definition of the "Unit" set forth in the Declaration (which generally) or by including the interior airspace between the perimeter walls and excludes interior structural components. For your reference, the area of the Unit, determined in accordance with those defined Unit boundaries, is set forth in Exhibit "C" to the Declaration. Note that measurements of rooms set forth on this floor plan are generally taken at the greatest points of each open room (as if the room were a perfect rectangle), without regard for any alcoves. Accordingly, the area of the actual room will typically be smaller than the product obtained by multiplying the stated length times width. All dimensions are approximate and may vary with actual construction, and all floor plans and development plans are subject to change.